

Outpatient Specialist Clinic			Clinic Hours: 8:30 am – 3:30 pm scheduling		August, 2010
Suite	Extension	Contact	Nurse Extension	Location	Staff
Suite A	2744	Lois Cooper	2746	Medical Arts West	ECHO Mon/Wed
Suite B	2823	Julie Buss-Coordinator	2737	Medical Arts West	Julie/Jodi
Suite C	2738	Terra Miller	2760	Medical Arts West	Margaret
Suite D	4010	Urology		Medical Arts West	Mon/Th/Fri
Suite E	2741/3612	Jodi Kruger	2841	Medical Arts West	Jodi/Nora

			Wed Sept 1st	Thurs Sept 2nd	Fri Sept 3rd
Suite A			Hart/Raval 8:00	Later	Hart 7:30-11:45
Suite B			Rao/Hearing Ctr	Rita-Hear/No Neph	No PM OP Clinics
Suite C			AMS Clinic	Centers for Pain	AMS/NE Neurology
Suite D				Koerner	Pollofrone-AM
Suite E			Hamdi-Neurology AM		Krach 7:45-11:45
Suite 1-East				Brandon PM	Justice-AM
Suite 2-East			Oncology 2 nd fl DMH	Mackel	Caudell/Mackel
Suite 102			IN/Ohio Heart	Ramrakhiani-GI	Jones/Rodriquez

	Mon Sept 6th	Tues Sept 7th	Wed Sept 8th	Thurs Sept 9th	Fri Sept 10th
Suite A	Genetos	No VenKat	Collis 8:00/No Raval	Later	Otten AM
Suite B	No Barbish	Westfall	Rao/Hearing Ctr	Ducker /Suzanne	Eby
Suite C	AMS Clinic		AMS Clinic	Centers for Pain	AMS/NE Neurology
Suite D	Pollifrone PM	Wound Clinic 2 nd fl	Oncology 2 nd floor	Koerner	
Suite E		Norton-PM	Hamdi/Neurology AM	Hear Care	Maples-AM
Suite 1-East		Justice-PM		Brandon-PM	Justice-AM
Suite 2-East	Snyder	Schwartz/Rahn		Mackel	Mackel PM
Suite 102	No Clinic	Ramrakhiani/Baney, NP		No Clinic	Jones/Rodriquez

	Mon Sept 13th	Tues Sept 14th	Wed Sept 15th	Thurs Sept 16th	Fri Sept 17th
Suite A	Genetos	VenKat	Collis 8:00/Raval	Later	Genetos 8:00/Phuong
Suite B	No Barbish	Westfall	Rao/Hearing Center	Rita-Hear	Eby/Suzanne
Suite C	AMS Clinic	Patel	AMS Clinic	Centers for Pain	AMS/NE Neurology
Suite D	Pollifrone-PM	Wound Clinic 2 nd floor	Oncology 2 nd fl DMH	Koerner	
Suite E		Norton-All	No Neuro-vacation		Krach-AM
Suite 1-East		Justice-PM		Brandon PM	Justice AM
Suite 2-East	Snyder	Schwartz /Rahn		Mackel	Caudell/Mackel
Suite 102	No Clinic	Ramrakhiani/Baney, NP	IN/Ohio Heart	Ramrakhiani-GI	Rodriquez

	Mon Sept 20th	Tues Sept 21st	Wed Sept 22nd	Thurs Sept 23rd	Fri Sept 24th
Suite A	Genetos	VenKat	Collis 8:00/Raval	Later	O'Shaughnessy
Suite B	No Barbish-GI	Westfall	Rao/Hearing Ctr	Ducker	No Eby
Suite C	AMS Clinic		AMS Clinic (all day)	Centers for Pain	AMS/NE Neurology
Suite D	Pollifrone PM	Wound Clinic 2 nd fl	No Clinic	Koerner	
Suite E		Norton PM	Oncology 2nd fl DMH	Hear Care	No Maples
Suite 1-East		Justice-PM	Hamdi-Neurology AM	Brandon PM	Justice-AM
Suite 2-East	Snyder	Schwartz /Rahn		No Clinic	Caudell/Mackel
Suite 102	No Clinic	Ramrakhiani/Baney, NP			Jones/Rodriquez

	Mon 27th	Tues Sept 28th	Wed Sept 29th	Thurs Sept 30th	
Suite A	O'Shaughnessy 8 AM	VenKat	Hart 8:00/Raval	Later	
Suite B	Barbish 8-12 Surg	Westfall	Rao/Hearing Ctr	Rita/Ducker	
Suite C	AMS Clinic		AMS Clinic	Centers for Pain	
Suite D	Pollifrone PM	Wound Clinic 2 nd floor	No Hamdi	Koerner	
Suite E		NortonAll			
Suite 1-East		Justice PM	Oncology 2 nd Fl DMH	Brandon PM	
Suite 2-East	Snyder	Schwartz/Rahn		Mackel	
Suite 102	No Clinic	Ramrakhiani/Baney, NP			

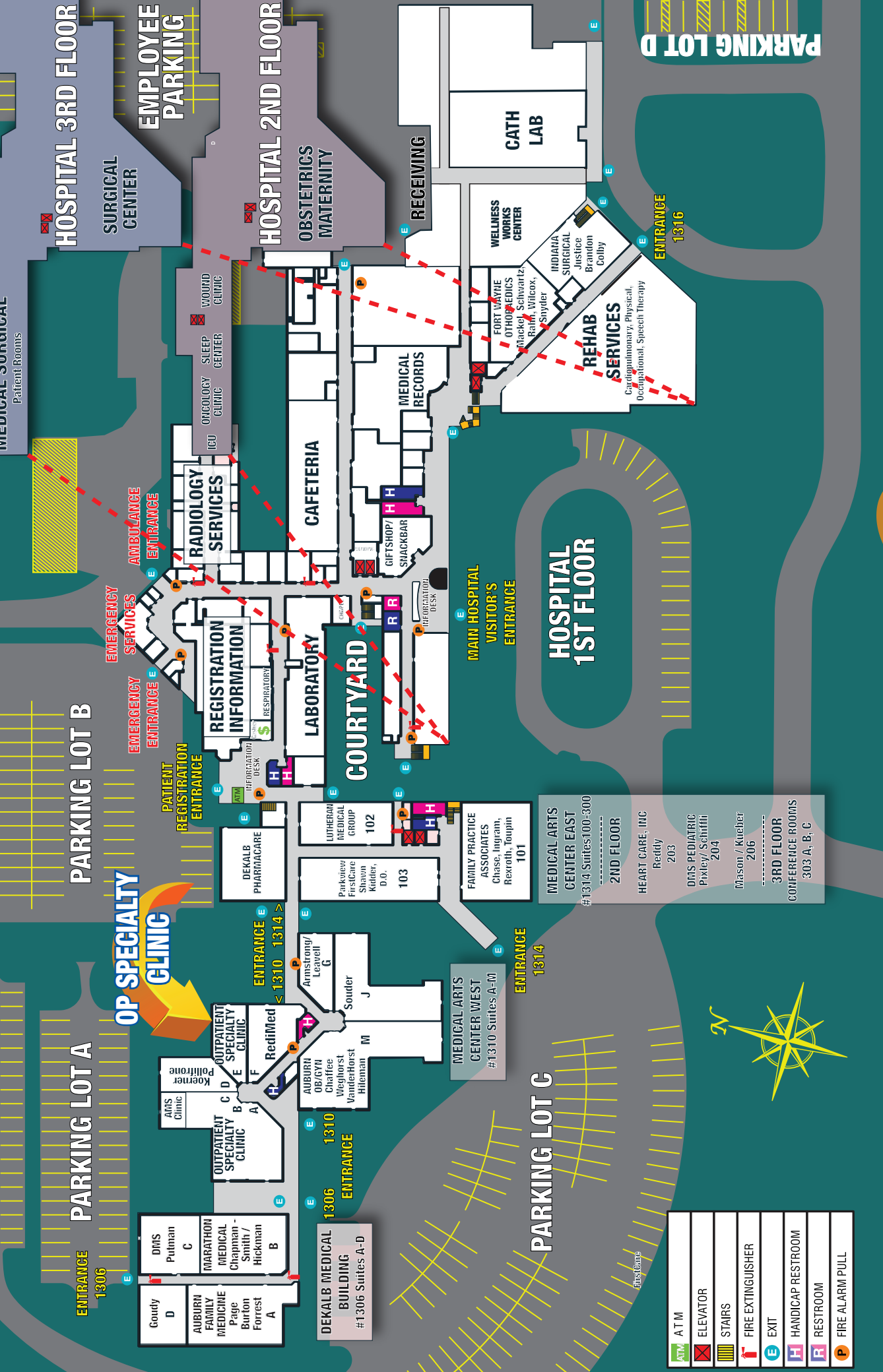

- ATM
- ELEVATOR
- STAIRS
- FIRE EXTINGUISHER
- EXIT
- HANDICAP RESTROOM
- RESTROOM
- FIRE ALARM PULL

PHYSICIAN'S OFFICES ARE LOCATED IN THE FOLLOWING BUILDINGS...

- DeKalb Medical Building (DMB) Suites A-D
- Medical Arts Center West (MAC WEST) Suites A-M (including OP Clinic Office Suites A-E)
- Medical Arts Center East (MAC EAST) Suites 100-300
- Main Hospital Suites 1, 2 (1st Floor) and 2nd Floor (Clinic) Entrance: #1306
- Entrance: #1306
- Entrance: #1310
- Entrance: #1314
- Entrance: #1316



DEKALB MEMORIAL
HOSPITAL, INC.

Outpatient Specialty Clinic
260.925.4600 ext. 2741 or 2744
Auburn, Indiana
dekalbmemorial.com

